

Solv-Ultima™ 150 Non-Electric Mix & Feed System for Solid Concentrates

Safe, Consistent Dissolution of Solid Concentrated Treatment Chemicals.....Without Power



Solv-Ultima™ 150: No Power Required

Drumless water treatment without electricity. This unit uses a system of *float-weights and mechanical solenoid valves* to automatically reconstitute solid chemical concentrates on-site.

Operation

When the level of mixed chemical in the reservoir drops, (due to chemical pump draw), the primary float-weight activates the primary solenoid valve allowing water to spray up into the bottle of chemical. Water sprays up & erodes, dissolves, & mixes solid chemical concentrate which gravity-drains into the self-contained reservoir/housing, until the primary float reaches the shut-off height & closes the solenoid. This fill, empty, & refill cycle will continue automatically, based on system demand. The second float-weight & solenoid is a safety (built-in spill containment).



A Solid Concentrate

- A. Solid form treatment
- Reconstitute on site
 - 1-gallon plastic bottles
 - Complete product line
 - Disposal- throw in trash
 - No drums to handle
 - No chemical exposure

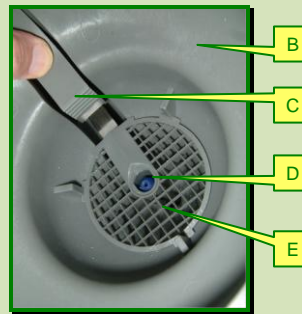

Mixing Bowl

- B. Molded mixing bowl
 C. Spray safety deactivation tab
 D. Spray nozzle (exposed)
 E. Product retention screen



F

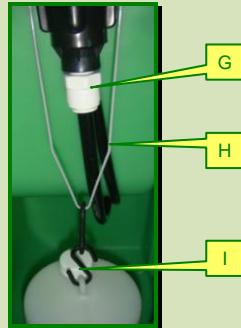

G

H

I

Operational Components

- F. Float weight (1 of 2)
 G. Water supply to solenoids
 H. Float-weight harness (1 of 2)
 I. S-hook connectors
 J. Mechanical solenoid (1 of 2)



J

***Patented Dual-Valve Overflow Safety System:** Should the primary solenoid valve remain stuck in the open position or if a leak-by occurs, the secondary float will activate, closing the overflow solenoid valve. (Non-powered magnetic mechanical solenoid valves)

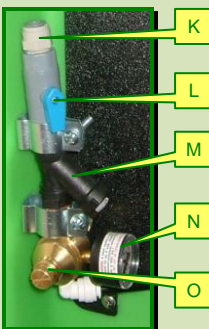

K

L

M

N

O

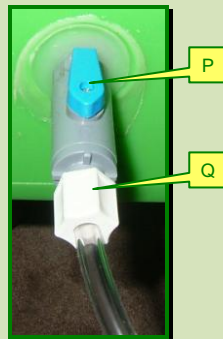

P

Q

Liquid-End Connections & Fittings

- K. Make-up line/water supply to board
 L. Isolation valve for water supply
 M. In-line Y-strainer/filter
 N. Pressure guage
 O. Pressure regulator (adjustable)
 P. Isolation valve (chemical supply)
 Q. Suction tube & fitting (to pump)



System Specifications

Net Weight	17 #	Flow Rate	1.2 gpm
Ship Weight	19 #	Spray nozzle	90°
Dimensions	33" W x 32" H x 9" D	Mounting	4 anchor bolts
Water Line Requirement	3/8" Make-Up	Assembly & Install Time	10-12 minutes (approx.)
Water Pressure	40 psi	Electrical Requirements	None

Richard Hourigan, Inc.
 Bear, DE

1-815-751-8131
www.TheWaterTreatmentStore.com